

TUB WALL PANEL INSTALLATION INSTRUCTIONS

The TUB WALL PANEL KITS are designed to fit standard 60" x 30", 60" x 32", 60" x 36" and 72" x 36" bathtubs. Sequence of mounting panels applies to wall units for 60" x 30" and 60" x 36" bathtubs. Installation of the wall panels for the 60" x 32" and 72" x 36" bathtubs should commence with the back panel followed by each of the side panels.

Materials Supplied by Taylor:

10 oz. Cartridges of RTV Silicone Adhesive
6 oz. Cartridge of Color Coordinating Silicone Sealant
"Perfect Bead" Tool / Instructions

Tools Required:

Caulking Gun
Belt Sander with 36 grit (coarse) belt
Coarse file or "Stanley Shurform"
Electric Drill with 1/4" bit
Saber Saw with 10 to 14 tooth per inch blade or
Carbide grit-edge blade
Hammer and nails (3" finishing)
Knife, Compass, Pencil and Plastic Spoon

Materials Required:

- (5) Pieces 1/4" x 4" x 18" plywood or hardboard
- (1) Piece scrap lumber for bracing
- Rubbing Alcohol or Lacquer Thinner
- Paper Towels
- Masking Tape

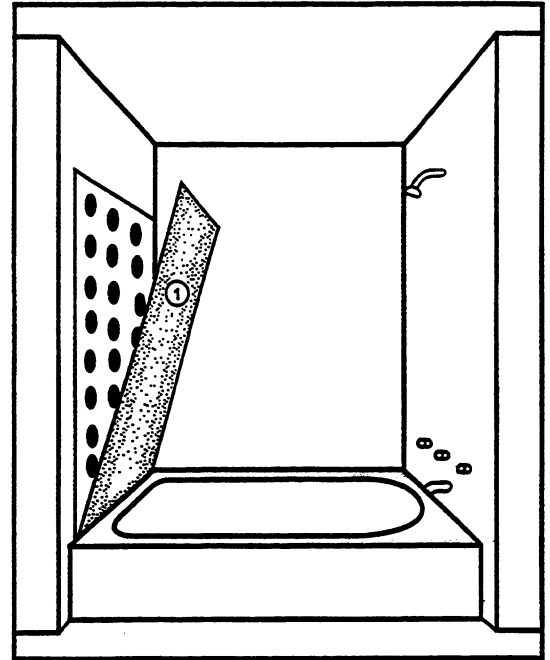

Fig. 1

- Step 1. The surface should be cleaned of all dirt, paint, wax, grease or other such finishes.
- Step 2. Place panel (1) into position (See Fig. 1). If the gap between the right hand edge and the back wall exceeds 1/4", sand or file edge of panels to reduce gap to 1/4" maximum. With a caulking gun, apply a 3" to 4" diameter circle of adhesive 1/4" thick on the wall (not the panel) on 8" to 10" centers as shown in Figure 1. Use approximately one full tube per panel. Place panel into position and press panel firmly into place. Panel should be positioned 1/16th inch above the tub deck surface. **CAUTION! DO NOT BEND PANEL TO CONFORM TO A BOWED WALL. THE RESILIENCY OF THE PANEL WILL BREAK THE BOND OF THE ADHESIVE TO THE WALL.**
- Step 3. Place masking tape on the finished side of panel (2) approximately in the location for the plumbing fixtures and mark the hole centerlines. Scribe a circle of the diameter required at each hole location. Drill a 1/4" diameter hole inside the circle and cut out the circle using a saber saw. Install panel (2) as described in Step 2.
- Step 4. Install panels (3) and (4) in a similar manner as described in Step 2, except that the gap at the end panel should be as small as possible (See Fig. 2 and 4).
- Step 5. Trim the (5) 1/4" x 4" pieces of plywood or hardboard to fit between panels (3) and (4) and attach to the back wall with nails and adhesive (See Fig. 2 and 5). Apply adhesive to the outside face of the wooden strips and put panel (5) in place (See Fig. 3).
- Step 6. Brace panels in position with scrap lumber for 24 hours.

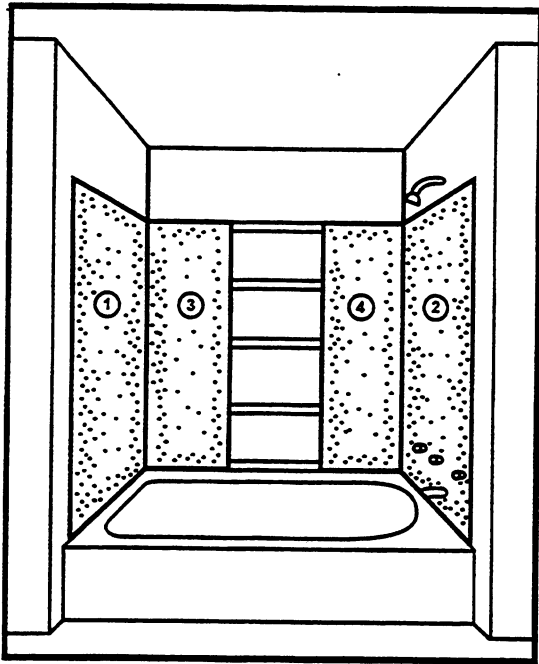

Fig. 2

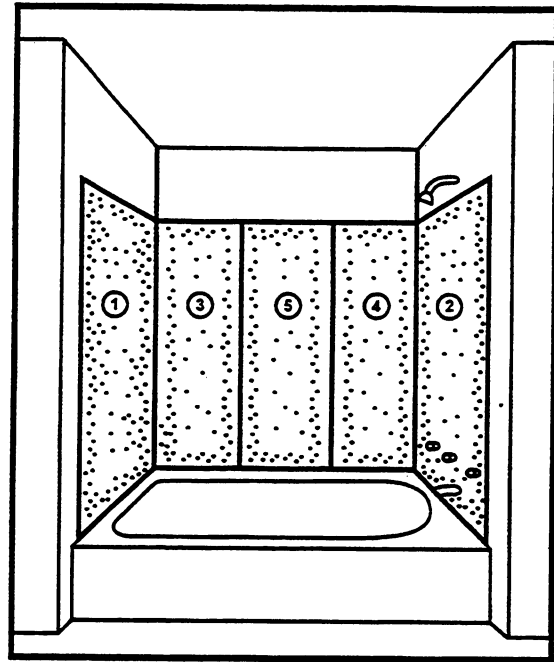

Fig. 3

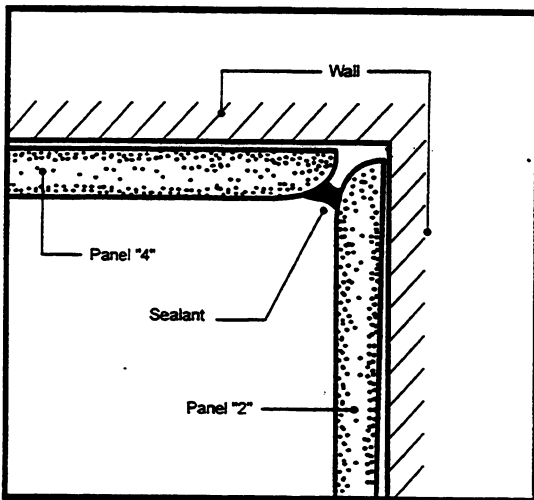

Fig. 4

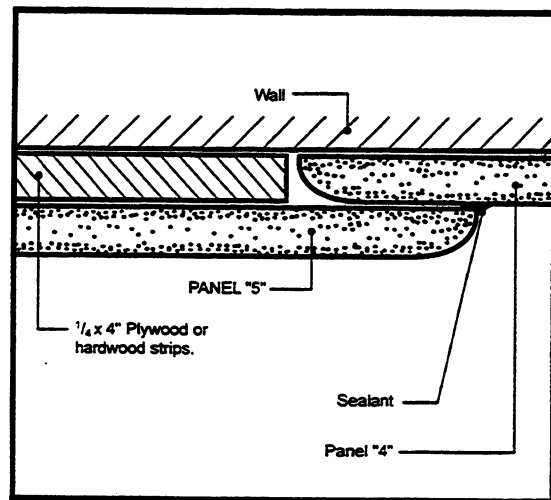

Fig. 5

Step 7. Remove bracing. Clean the joints with solvent. Apply a bead of silicone to the joint forcing the silicone deep into the joint. Tool the joint within 5 minutes with the supplied "Perfect Bead" tool. To clean up, wait until the silicone has set (about 30 minutes), then scrape the excess "firm" silicone from the panels with a plastic spoon (the plastic spoon will not scratch the gel-coated surface of the panels or base, do not use metal!).

NOTE:

Corner Molding, Edge Molding and Batten Strips are available to cover corners and joints for the impossible situations or if a different look is desired. Various size trim kits are available to accommodate different bathtub dimensions. Soap and Shampoo Holders are also available and can be installed after the wall panels are installed by cutting the proper sized hole and gluing the holder in place with silicone. If minor scratches occur during installation, refer to our "Care and Maintenance Instructions" or "Buffing Out Surface Scratches". Any adhesive residue can be removed with Lysol Tub and Tile Cleaner or paint thinner.